



REGO-FIX presents the new ATC-E 15

Defining precision in a new dimension

INNOVATIVE

In 1972 REGO-FIX invented and introduced the ER collet, which became the industry standard according to DIN 6499 worldwide.

PRECISE

Thanks to our long tradition and experience in manufacturing high-precision clamping systems, REGO-FIX is proud to announce the new tool holding system ATC-E 15.

ATC-E 15 HOLDER

Fast, precise and optimised for micro-machining, REGO-FIX offers four different toolholders for the new standard.

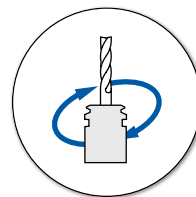

Balanced up to 80000 revolutions per minute



100% manufactured in Switzerland

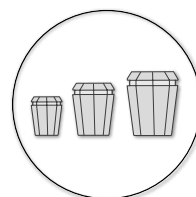

Clamping diameters from 0.2–7 mm

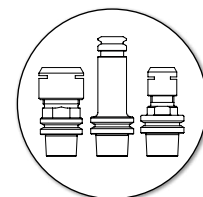

Available in SR 6, ER 8, ER 11 and powRgrip® PG 6

Standard program range available:

5915.20600 ATC-E 15/SR 6 x 022 (SR System)

- // Clamping diameter 3 mm & 1/8"
- // Smallest possible outer diameter (O.D.)

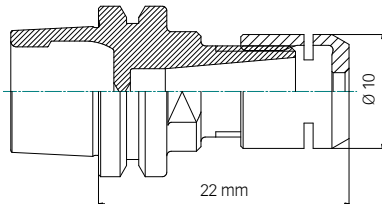

ATC-E 15/SR 6 x 022



SR 6

2915.10800 ATC-E 15/ERMS 8 x 021 (ER System)

- // Clamping diameter 0.2–5 mm
- // All advantages as per ER 8 (DIN 6499)

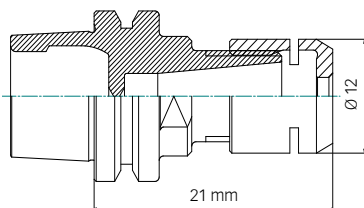

ATC-E 15/ERMS 8 x 021



ER 8-UP

2915.11100 ATC-E 15/ERMS 11 x 024 (ER System)

- // Clamping diameter 1–7 mm
- // All advantages as per ER 11 (DIN 6499)

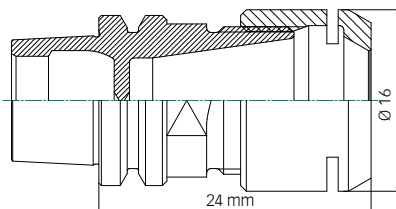

ATC-E 15/ERMS 11 x 024



ER 11-UP

2915.70600 ATC-E 15/PG 6 x 034 (powRgrip® System)

- // Clamping diameter 0.2–4 mm
- // Excellent concentricity and clamping force thanks to PG

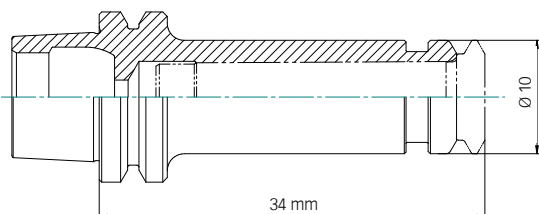

ATC-E 15/PG 6 x 034



powRgrip® PG 6

Recommended tightening torque		
Size	Ø [mm]	[Nm]
SR 6	3.0 & 1/8"	4
ER 8 MB	0.2–0.9	6
ER 8-UP	1.0–5.0	6
ER 11 MB	0.2–0.9	8
ER 11-UP	1.0–7.0	10